

# OPERATOR'S MANUAL

636088

## 636088 and 636089 Swivel 3/8 - 18 N.P.T.F.

636089

RELEASED: 10-16-56  
REVISED: 8-17-05  
(REV. 03)

DO NOT EXCEED MAXIMUM WORKING PRESSURE OF 10,000 P.S.I. (689.7 BAR).

### 636088 / 636089 PARTS LIST

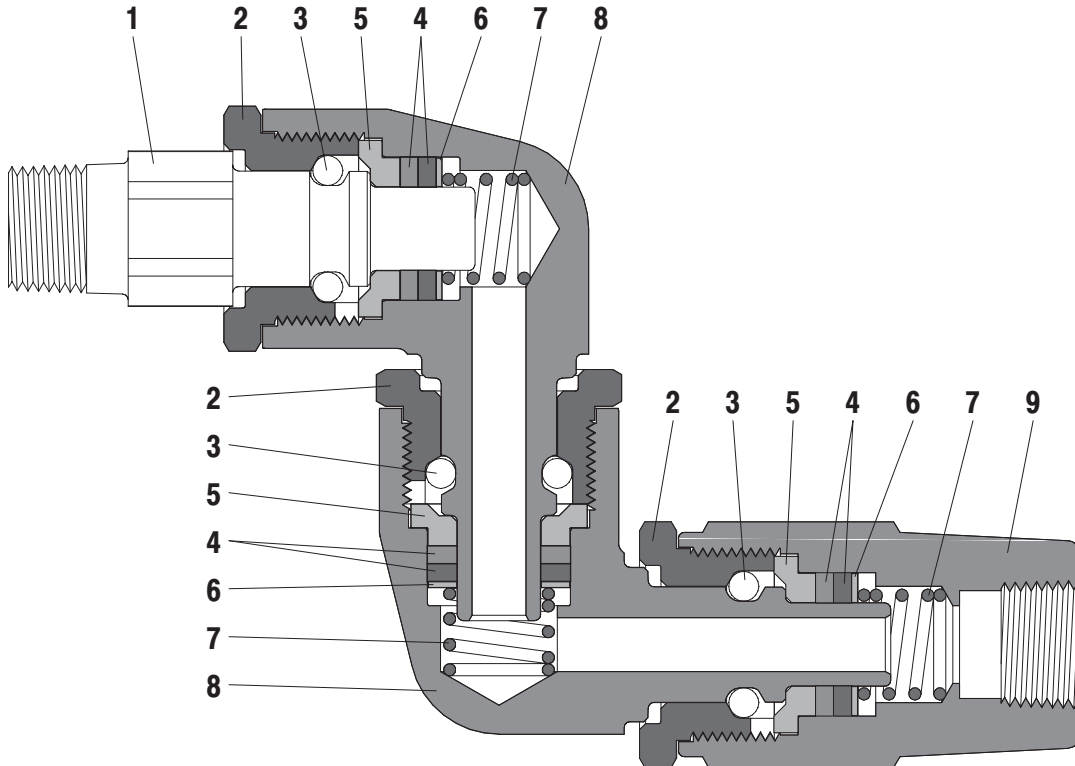

### PARTS LIST

| Item | Description (size)                 | Qty  | Part No. | Item | Description (size)         | Qty | Part No. |
|------|------------------------------------|------|----------|------|----------------------------|-----|----------|
| 1    | Stem (3/8 - 18 N.P.T.F.)           | (1)  | 4114-1   | 5    | Packing Retainer           | (3) | 4111     |
| 2    | Swivel Gland                       | (3)  | 4113     | 6    | Washer                     | (3) | F174-17  |
| 3    | Ball (0.1562 dia.)                 | (36) | Y16-205  | 7    | Spring                     | (3) | F51-44   |
| 4    | Packing (models 636088 - Neoprene) | (6)  | F26-61   | 8    | Swivel Elbow               | (2) | 4110     |
|      | (models 636089 - Leather)          | (6)  | 77872    | 9    | Swivel (3/8 - 18 N.P.T.F.) | (1) | 4115-1   |

PN 97999-166

INGERSOLL-RAND COMPANY  
P.O. BOX 151 • ONE ARO CENTER • BRYAN, OHIO 43506-0151

☎ (800) 276-4658 • FAX (800) 266-7016 ©2005 CCN 81377301

